



Stainless Prong Snap

HISANAGA

Yotsukaido Industrial Park 598
 Monoi, Yotsukaido-shi Chiba 284-0012 JAPAN
 Tel +81(43)422 2112 · Fax +81(43)423 7147
 overseas.crown@hisanaga-ss.co.jp

ST-60 Series

Meets the safety, design and reliability requirements of major buyers.

[Usage] Using rust-resisting materials. Suitable for medical garments, working wear and so on.

TOP PARTS

PRONG



ST-82A / LA

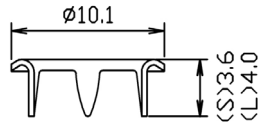

other combination



ST26A / 12mm



ST27A / 15mm

FABRIC

SOCKET



ST-60B

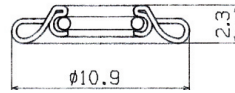

Combination of Top parts & Socket

Regular prong	
Basic pinch	2.70mm
Max attached height	3.30mm
Holding strength	over 9.20kg
Long prong	
Basic pinch	3.10mm
Max attached height	3.80mm
Holding strength	over 9.20kg

UNDER PARTS (3PARTS)

STUD



ST-85CW

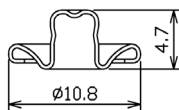

ST-82C

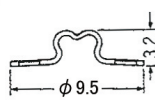

Combination of Socket & Stud(ST-85CW)

Closing snap action	3.5 ~ 6.5kg
Opening snap action	0.9 ~ 1.5kg
Combination of Socket & Stud(ST-82C)	
Closing snap action	3.5 ~ 6.5kg
Opening snap action	0.9 ~ 1.5kg

FABRIC

PRONG



ST-82 / LA

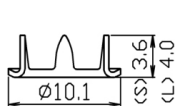

POST



ST-82D

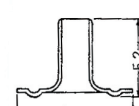

Combination of Under parts & Stud

Regular prong	
Basic pinch	2.70mm
Max attached height	3.30mm
Holding strength	over 9.20kg
Long prong	
Basic pinch	3.10mm
Max attached height	3.80mm
Holding strength	over 9.20kg

Combination of Under parts & Stud(ST-82)

Basic pinch	1.55mm
Max attached height	2.60mm
Holding strength	over 9.20kg